

4

3

2

1

THIS DRAWING IS UNPUBLISHED.

RELEASED FOR PUBLICATION ,19 .

© COPYRIGHT 19

BY AMP INCORPORATED. ALL RIGHTS RESERVED.

LOC

DIS

REVISIONS

G

86

P

LTR

DESCRIPTION

DATE

DWN

APVD

D

REVISED & REDRAWN PER 0720-0856-96

21JUN96

DKS

WJV

STRAIGHT KNURL

5.61
[.221]
MAX DIA

21.46
[.845]
MAX

53853-2

AMP
PART NUMBER

THIS DRAWING IS A CONTROLLED DOCUMENT FOR AMP INCORPORATED.
IT IS SUBJECT TO CHANGE AND THE CONTROLLING ENGINEERING
ORGANIZATION SHOULD BE CONTACTED FOR THE LATEST REVISION.

DWN DK SCHRUM 21JUN96

CHK WJ VOCKROTH 25JUN96

APVD JL MECKLEY 25JUN96

PRODUCT SPEC

APPLICATION SPEC

WEIGHT - lbs

CUSTOMER DRAWING

AMP AMP Incorporated
Harrisburg, PA 17105-3608

NAME
PIN, QUICK-DISCONNECT,
AMPOWER™

SIZE A3 CAGE CODE 00779 DRAWING NO C-53853

SCALE 5:1 SHEET 1 OF 1 REV D

DIMENSIONS:
mm [INCHES]

TOLERANCES UNLESS
OTHERWISE SPECIFIED:

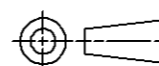

- 0 PLC ±-
- 1 PLC ±-
- 2 PLC ±0.20 [.008]
- 3 PLC ±-
- 4 PLC ±-
- ANGLES ±-

MATERIAL
BRASS
PER QQ-B-626

FINISH SILVER PL
0.00508 [.000200] MIN
THK PER QQ-S-365