

P.C.B MOUNTING

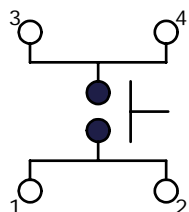

CIRCUIT: SPST

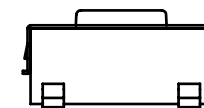
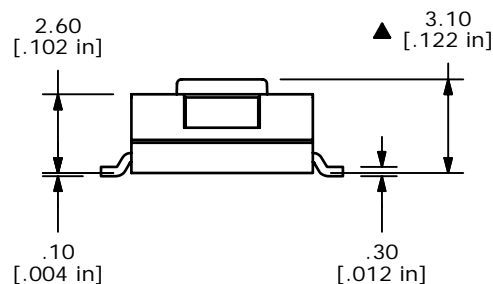
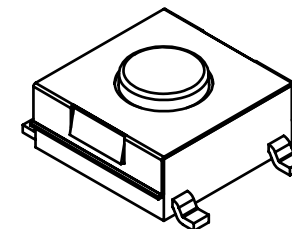
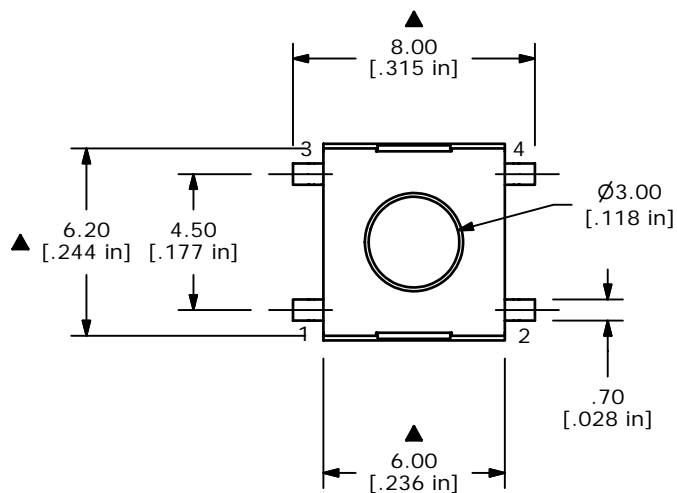

TERMINALS TO BE COPLANAR WITH IN 0.10 TOTAL

NOTES:

1. ALL DIMENSIONS IN MM [INCH]
2. GENERAL TOLERANCE: X.X=±0.4  
X.XX=±0.25
3. TERMINAL NUMBERS FOR REF ONLY.
4. TRAVEL: 0.25mm +0.2/-0.1
5. RATING: 50mA, 12VDC
6. OPERATING FORCE: 260±50gf
7. CONTACT RESISTANCE: 100M OHM MAX.
- ▲ 8. ACTUATOR COLOR: BLACK
9. ▲ DENOTES CRITICAL PARAMETER
- ▲ 10. PACKAGING: TAPE AND REEL 1,500 PCS PER
- ▲ 11. 2002/95/EC (ROHS) COMPLIANT

**E-SWITCH®**

TITLE TL3303F260QG

D	15915	REVISED REDRAWN	3/29/06	PH
REV	PCR NO	DESCRIPTION	DATE	BY

THE INFORMATION CONTAINED IN THIS DOCUMENT IS PROPRIETARY TO E-SWITCH AND IS NOT TO BE COPIED OR TRANSFERRED

SCALE	DATE	DR	DWG	REV
4:1	3/29/2006	PH	P010346	D