

Panel feed-through - VS-PPC-F2-MSTB-MNNA-1R-SPSA5 - 1608249

Please be informed that the data shown in this PDF Document is generated from our Online Catalog. Please find the complete data in the user's documentation. Our General Terms of Use for Downloads are valid (<http://download.phoenixcontact.com>)



Push/pull panel mounting frame, metal, version 14, including contact insert with spring-cage connection, fixed 24 V coding according to Guideline for PROFINET, for rectangular mounting cutout, with seal, without fixing screws



Key commercial data

Packing unit	1 1
Weight per Piece (excluding packing)	61.8 GRM
Custom tariff number	85366990
Country of origin	Germany

Technical data

Mechanical characteristics

Number of positions	5
Locking type	Push Pull
Insertion/withdrawal cycles	≥ 100
Connection method	Spring-cage conn.
Conductor cross section	0.75 mm ² ... 2.5 mm ²
Connection cross section AWG	18 ... 13
Color	silver

Ambient conditions

Ambient temperature (operation)	-40 °C ... 70 °C
Degree of protection	IP65/67

Material data

Inflammability class according to UL 94	V0
Housing material	Zinc die-cast
Housing surface material	Nickel-plated
Contact carrier material	PA

Panel feed-through - VS-PPC-F2-MSTB-MNNA-1R-SPSA5 - 1608249

Technical data

Material data

Contact material	Copper alloy
Contact surface material	Gold over nickel
Material	Metal
Sealing material	NBR
Seal material	NBR

Electrical characteristics

Number of positions	5
Rated current	16 A (at 20 °C)
Pollution degree	2

Classifications

eCl@ss

eCl@ss 4.0	24190219
eCl@ss 4.1	24190219
eCl@ss 5.0	27400209
eCl@ss 5.1	27400209
eCl@ss 6.0	27400209
eCl@ss 7.0	27440304
eCl@ss 8.0	27440304

ETIM

ETIM 3.0	EC000516
ETIM 4.0	EC000516
ETIM 5.0	EC002310

UNSPSC

UNSPSC 6.01	31261501
UNSPSC 7.0901	31261501
UNSPSC 11	31261501
UNSPSC 12.01	31261501
UNSPSC 13.2	31261501

Approvals

Approvals

Panel feed-through - VS-PPC-F2-MSTB-MNNA-1R-SPSA5 - 1608249

Approvals

Approvals

GOST

Ex Approvals

Approvals submitted

Approval details



Drawings

Dimensioned drawing

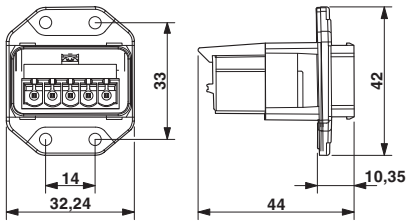

Push-Pull MSTB panel mounting frame

Dimensioned drawing

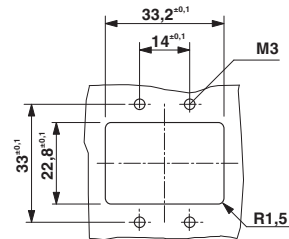

Panel cutout